



www.FleetwoodRV.com

**FORD® CHASSIS**

Model: Ford®

Engine: 7.3L Triton V8

Transmission: Ford® 6-Speed, Automatic w/Overdrive

Alternator: 175 Amp

Torque: 468 lb.-ft. @ 3,000 RPM

Horsepower: 350HP @ 3,900 RPM



**33HB** Options: 096, 105, 126, 131, 194, 230, 470, 471, 580, 605, 953

**TOP FLOORPLAN FEATURES**

- Sleeps up to 6
- Bath-and-a-Half
- C-PAP Storage in Bedroom Overhead Cabinetry
- 40" LED Smart TV in Living Room
- Additional Wardrobe and Dresser Bedroom Storage
- Additional Exterior Storage Above the Belt Line

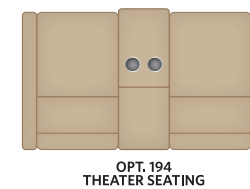
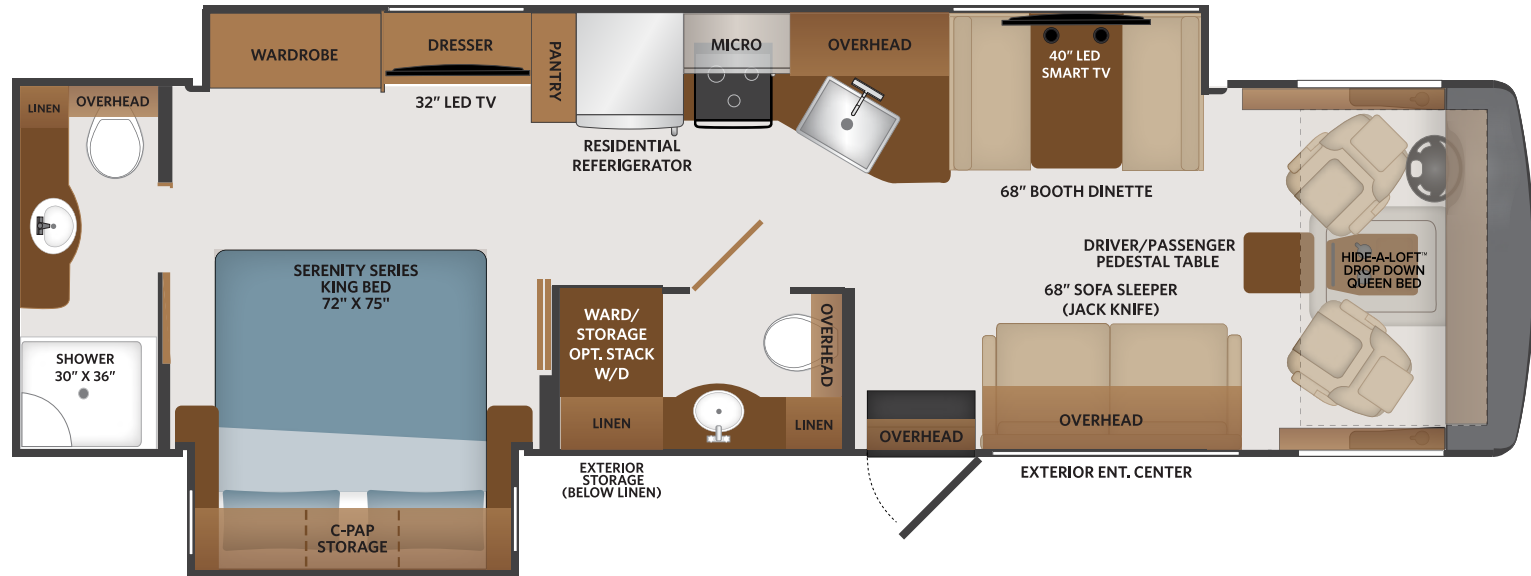

<b>FORTIS OPTIONS</b>	096	KING® Universal Satellite System	194	Theater Seating	580	Collision Mitigation
	105	Dometic 8CF Double Door Refrierator - LP	230	Roof Vent Rain Covers	605	Dual Glazed Windows
	126	Washer/Dryer — All in one combo	470	SumoSprings® - Front/Rear	953	Power Driver Seat
	131	Washer/Dryer — Stackable	471	Steering Stabilizer System		

**FLOORPLAN 33HB**

**2022** | CLASS A GAS **FORTIS**