



www.FleetwoodRV.com

**37F** Options: 048, 089, 096, 113, 126, 194, 220, 304, 333, 470, 471, 580

#### TOP FLOORPLAN FEATURES

- Sleeps up to 7
- Two Full Baths
- Bunk Bed converts to Wardrobe
- Solid Surface Galley Tops with Covers
- 4-Point Fully Automatic Hydraulic Leveling Jacks
- Tow Hitch Rating 8,000#
- Chassis 26,000#

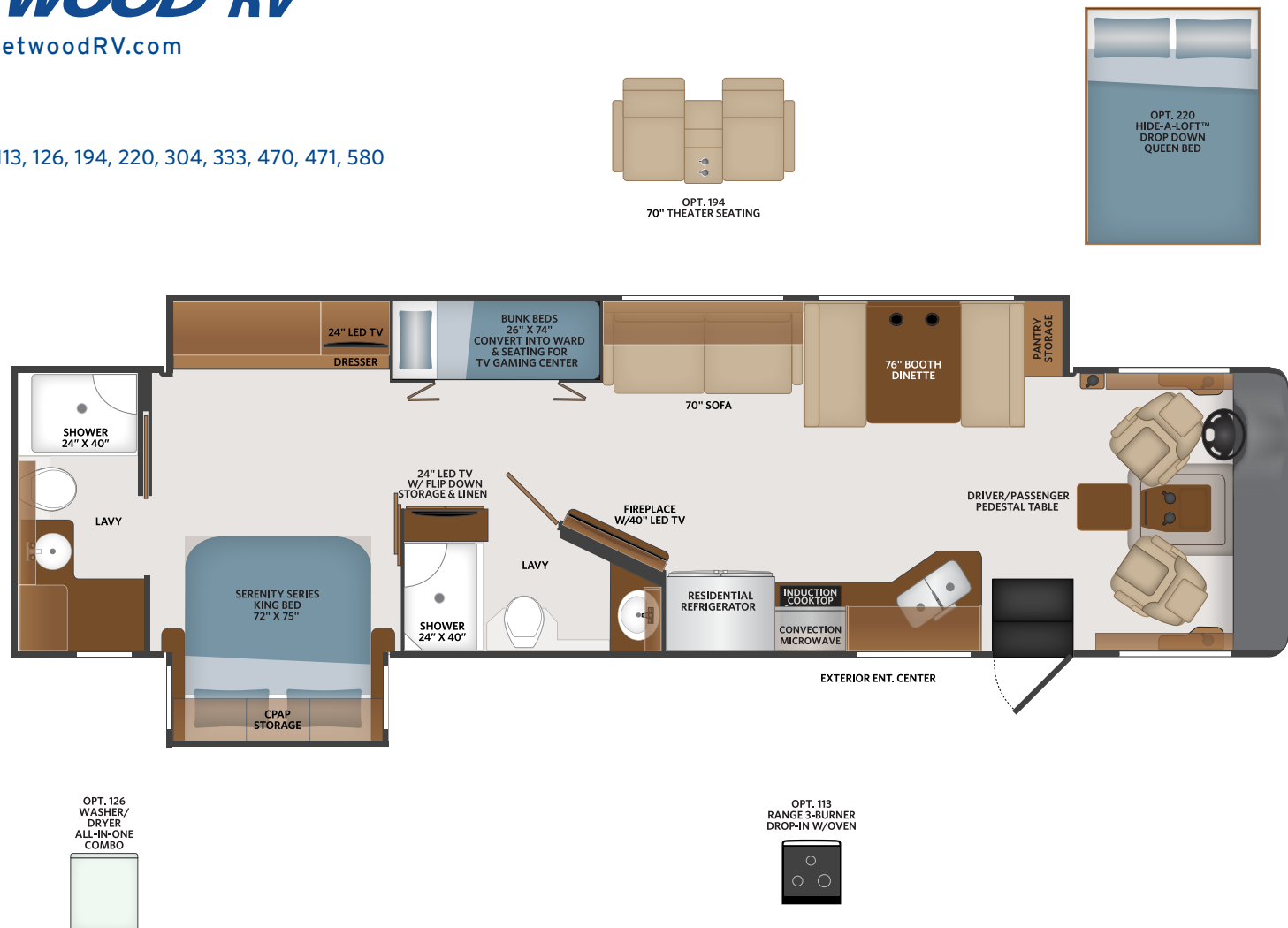

SOUTHWIND  
OPTIONS

048	Exterior Stainless Steel Accent Package	194	Theater Seating	471	Steering Stabilizer System
089	Upgraded WiFi Package	220	Hide-A-Loft™ Drop Down Queen Bed	580	Collision Mitigation
096	KING® Universal Satellite System	304	Solar Electrical Panel (265w)		
113	Range -3 Burner Drop-in w/Oven	333	7.0KW Generator		
126	Washer/Dryer — All in one combo	470	SumoSprings® - Front/Rear		

#### FORD® CHASSIS

Model: Ford®

Engine: 7.3L Triton V8

Transmission: Ford® 6-Speed, Automatic w/Overdrive

Alternator: 175 Amp

Torque: 468 lb.-ft. @ 3,000 RPM

Horsepower: 350HP @ 3,900 RPM



# FLOORPLAN 37F

20  
22

CLASS A GAS  
SOUTHWIND