



2021 CLASS A GAS | BOUNDER



For our patented gas chassis, we take the Ford® drivetrain and create a solid platform to build on. The result is enhanced balance and control, as well as the strength to carry more weight. The design also allows for larger pass-through storage.



The Power Platform Chassis™

The Power Platform puts strength, stability, and reliability front and center. Perfect for trips requiring large carrying capacities, and built to store everything you need with spacious pass-through storage, the Power Platform is the ideal chassis for optimum balance and control — Found on Fleetwood BOUNDER gas motorhomes.

Every new adventure requires a solid foundation. The Power Platform chassis is designed with balance, control, a smooth ride, and ample space in mind, all working together to give you a ride like no other RV can provide.

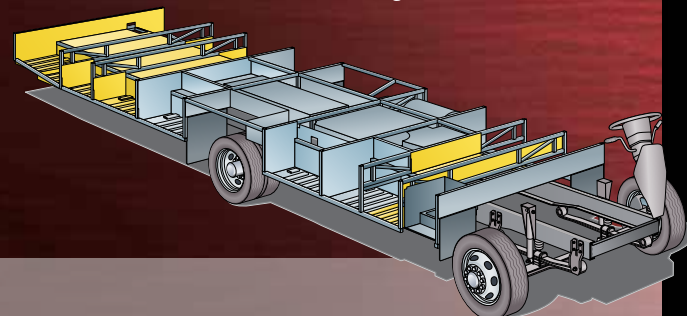

RV OWNERCARE

Limited one-year/15,000-mile coach warranty and three-year/45,000-mile structural warranty, whichever occurs first, and it is fully transferable for the first 12 months. RV OWNERCARE is one of the RV industry's most comprehensive programs and includes systems, appliances, components and construction, with no deductible and no service charge.

Chassis Warranty provided by Ford®



We build strength and quality from the inside out.

Fleetwood's exclusive Powerlock™ system is integrated into all Fleetwood RV Class A Gas models.

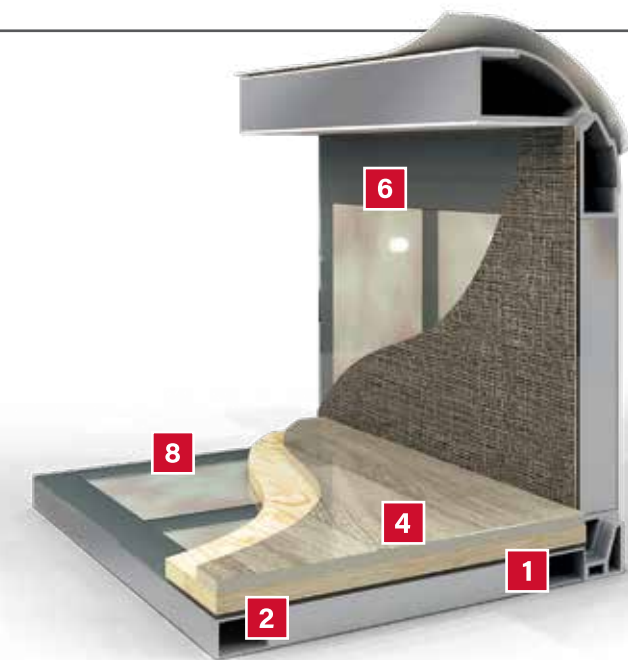

At Fleetwood, we don't settle for anything less than the best and neither should you. That is why every Fleetwood features industry-leading materials and construction standards.

1 PowerLock System™

Interlocking Floors, Walls, Ceiling

Fleetwood's interlocking aluminum extrusion wall-joint system integrates floor, sidewall and roof assembly into one locked-together overall structure for long-term performance and durability.

2 Precision Welded Joints

The all aluminum hull structure is engineered and built to precise tolerances and then precision welded to ensure strength and durability on even the roughest road trip.

At Fleetwood RV, it's not just what you see that matters. It's what you don't.

3 Tuff-Coat Fiberglass Walls

Thicker than other manufacturers, our Tuff-Coat fiberglass walls provide a durable skin and is the perfect surface for an automotive style finish.

4 Thick Robust Floor

Thicker than the industry standard, Fleetwood engineered the floor for more sound deadening and more insulation which results in a quieter, more comfortable ride no matter the weather or terrain outside.

5 Solid Bead-Foam Insulation™

Fleetwood's above-standard insulation material and process doesn't allow settling or air gaps to form. There is no forcing the precision cut insulation into position like the roll-type pink fiberglass insulation used by other manufacturers.

6 Loctite® Industrial Adhesive

Engineered to meet bonding, sealing and assembly requirements for a durable structure with no de-lamination.

7 No Wood Substrate

Unlike most Class A motorhome manufacturers, you won't find any wood substrate on the exterior walls.

8 1/2" Plywood Subfloor

Thicker than most competitors who use OSB or chip board, the integrated 1/2" subfloor provides a solid surface for flooring and eliminates movement and flexing while traveling.

9 Vacu-Bond™ Construction

Fully sealed and weather-resistant, the vacuum-bonded assemblies combine materials and construction for a straight, solid integrated wall that is better suited to withstand the rigors of the road. An adhesive bonding process applies up to 415,000 pounds of vacuum pressure to the welded-aluminum sidewall frame, bead-foam insulation, thick Tuff-Coat fiberglass skin and inner wall materials, far exceeding industry standards.

10 CNC Precision Routed Walls and Floors

Computer driven routers precisely route walls and floors to fit exact specifications to eliminate gaps, misalignments and provide for a more solid integrated overall structure.



Each of these advantages have been engineered to deliver superior reliability, durability and most of all, customer satisfaction.



THE LEGEND THAT KEEPS SETTING THE BAR.

Bounder has leapt into owners' hearts for the past 35 years. In fact, this Fleetwood model is the best-selling RV of all time. With credentials like that, you can be sure this Bounder has a winning combination of power, style and convenience.

It starts with our exclusive Power Platform® chassis, which creates the perfect base for maximum balance and control. It also allows you to carry more weight. Comes standard with a hitch rating up to 8,000 lbs and the bus-style, side-swing aluminum luggage doors make it easy to load up the pass-through storage.

The premium four-color, full-body paint job not only looks great, but increases durability. Surge protection safeguards your motorhome from costly electrical damage. And standard features like a fireplace on a stylish feature wall and an exterior entertainment center make it easy to call this RV home.

After decades at the front of the motorhome pack, Bounder knows no limits.



BOUNDER 36F
Shown in Pacific



We Interrupt This Magazine For An Important Introduction



A Motor Home That Really Works

It's the exciting new Bounder by Fleetwood, and you are the reason it exists.

Bounder offers you more of what you've been looking for in an RV: • More storage space and larger tank capacities for extended

travel • Easier serviceability for on the road convenience • Greater traveling comfort with spacious floorplans, panoramic view windows and reliable systems.

Feature for feature, Bounder also offers you more value.

Compare it with the competition, and we think you'll agree. It's an innovative, rugged, affordable, comfortable motor home. There's simply no other like it.

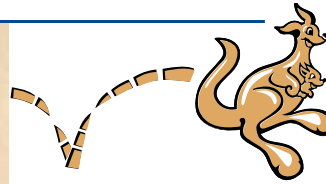

As we celebrate our 35th Production Year Anniversary of Bounder we would like to share with you a little history about the BEST-SELLING MOTORHOME of all times. Fleetwood is one of the oldest, most respected and recognizable names in the RV industry and it's products like the Bounder helps us achieve these accolades. Our history is rich with innovation and imagination. Over the years we have brought a balance of creativity, function and livability and luxury to life.

BOUND FOR GLORY

Adapted from Fred Smith's: The History of the Fleetwood Bounder

Fleetwood Enterprises founder John C. Crean, a charismatic visionary and pioneer of the RV Industry, believed there was little to be learned about how a given RV might fare in the marketplace by looking at charts and graphs in a boardroom. "Instead of hiring consulting companies and commissioning endless studies," urged Crean, "why not just get out there in the world and see what works?"

Crean believed that an RV was a house first and a vehicle second. In the spring of 1985, locked away by himself, Crean designed and built a prototype motor home that would soon turn the industry's conventional wisdom-of-the-day on its ear. Comfortable as he usually was when the rest of the RV industry thought he was crazy, Crean set about outfitting a prototype with touches that made it feel like a residential home.

Crean's instincts as both a product developer and entrepreneur lead him to two logical conclusions about his completed prototype. It was functional in a way no RV ever was, and it was ugly. Real ugly. So in the summer of 1985, Crean and Fleetwood's associates took the prototype on a 2,000-mile trip to visit about 15 RV dealers in Las Vegas, Salt Lake City, Sacramento, and down the San Joaquin Valley. Despite initial reactions, Crean was confident that his coach's functionality would win over dealers, and he was right.

Crean suggested the new unit be called the Bounder. He grabbed a napkin at a lunch meeting with his marketing team to illustrate his idea. He drew a picture of a jumping kangaroo "bounding from one place to another." Crean suggested the marketing team "take the drawing to a real illustrator to make it look less like a starving rodent." They did, and the result has become one of the most recognizable symbols the RV industry has ever known.

Upon its release to the market in 1985, Bounder was an immediate success. RVer's applauded its features and fell in love with its basement storage. Fleetwood touted Bounder as "A Motor Home That Works." Customers and dealers agreed as the "ugly duckling with the heart of a swan" quickly soared to #1 in sales performance. Among the Bounder's initial owners were the Creans, who purchased one of the first units off the line. "We took a lot of trips in it, and whenever we'd pass another Bounder, the people in it would be waving to us like crazy," recounted Crean. To this day, Bounder is the bestselling RV on the road.



BOUNDER 35K

Shown in Quicksilver Decor with Greystone Cabinetry



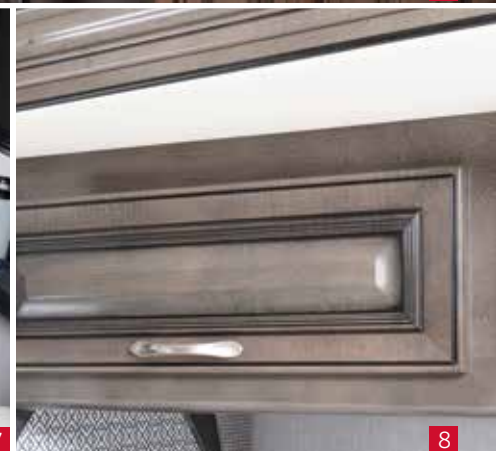

1 Residential style kitchen with all the amenities of home and stylish tile backsplash

2 Ample seating for everyone creates a cozy living space for entertaining guests or just relaxing with the family

3 Meal prep with ease with solid surface countertops that provides additional work space

4 Residential faucet w/single handle and pull-out sprayer to keep clean up fast and easy

5 New for '21 Driver/Passenger caddy area with three cupholders, USBs and various storage compartments

6 Driver and Passenger seating rotates giving more entertaining gathering space for guests

7 Passenger seating desk area creates a perfect office space to work while on the road with plenty of room for a laptop and utilizing the dash USBs conveniently located

8 Thoughtful storage throughout and ozite-lined cabinet interiors for noise absorption



1 Fiberglass shower surround with a glass shower door and skylight for extra head room

2 King-Sized Memory Foam Mattress is standard in each Bounder and designated C-PAP machine storage

3 Large wardrobe and storage space on all floorplans

4 New Heritage painted wood cabinetry option adds a classic look to any decor

5 Several lavatory options
Check-out the floorplans on pages 14-15

6 Hidden Euro-style hinges and struts and hardwood cabinetry construction

7 Lavy storage options on all floorplans to keep all the essentials within easy reach

BOUNDER 35K

Shown in Quicksilver Decor with Greystone Cabinetry



**BOUNDER 35K**

Shown in Oceanview Decor with Oxford Cabinetry





1 40" Flat Screen LED TV on a swing arm so there isn't a bad viewing seat in the house and an electric fireplace

2 Intricate stitching and eye catching furniture designs

3 Passenger chair with manual footrest, reclining back and swivel

4 Facing booth dinette with Dreameasy® dinette table that converts to additional sleeping space and includes storage

5 Tons of basement storage depending on the floorplan ranging from 160-180 cu. ft.

6 Large galley window with tiled window box on 33C, 35K and 36F

7 Thoughtful storage throughout hardwood cabinetry and ozite-lined cabinet interiors to cut-down road noise



BOUNDER 35P
Shown in Oxford Cabinetry



1 Tons of storage in the masterbed room wardrobe with set of drawers, full closet and full-length mirrors

2 Bounder 35P has endless pantry and linen closet space to have your needs right with you and organized

3 L-shaped sofa cabinetry option makes a great end-table and has deep storage, two-tiered shelving

4 The 35P floorplan features a 98" sofa sleeper (jack-knife) shown here open for additional guests

5 Storage galore using all available space in furniture configurations

6 Aerodynamic fiberglass cap with automotive-style head lighting and remote power heated mirrors w/turn indicators and side cameras are standard

7 Creative solutions to keep living on the road just like at home, 35P pull-out cabinetry cutting board and additional countertop space

BOUNDER 35K

Shown in Quicksilver Decor with Greystone Cabinetry



BOUNDER INTERIOR DESIGNER RECOMMENDS:

Oceanview Decor with Oxford or Greystone Cabinetry
Quicksilver Decor with Heritage or Greystone Cabinetry
Sycamore Decor with Cappuccino or Heritage Cabinetry
Create a customized look that reflects your personal style.

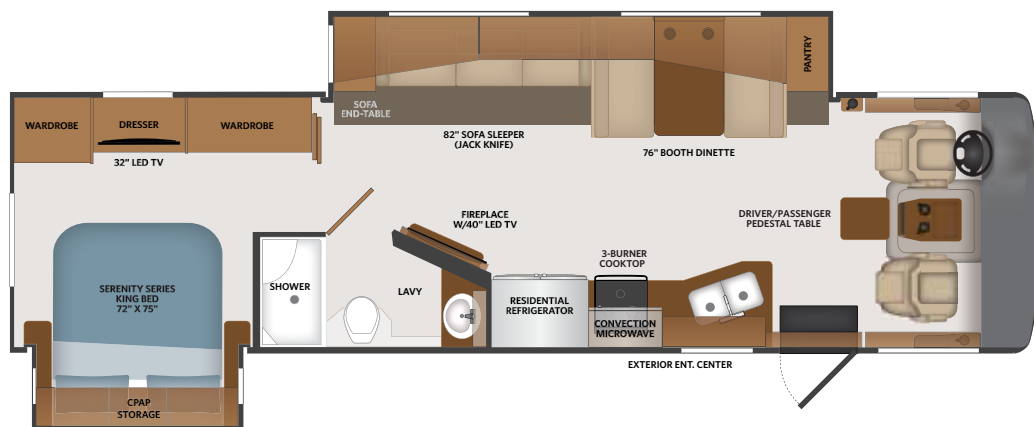
**33C**

Options: 089, 096, 113, 126, 194, 220, 304, 470, 471, 559, 580, 671, 833

TOP FLOORPLAN FEATURES

- Sleeps up to 6
- Open Living Area
- Dual Dash Monitors
- Fiberglass Shower w/Skylight
- 2000W Inverter
- Full Body Paint

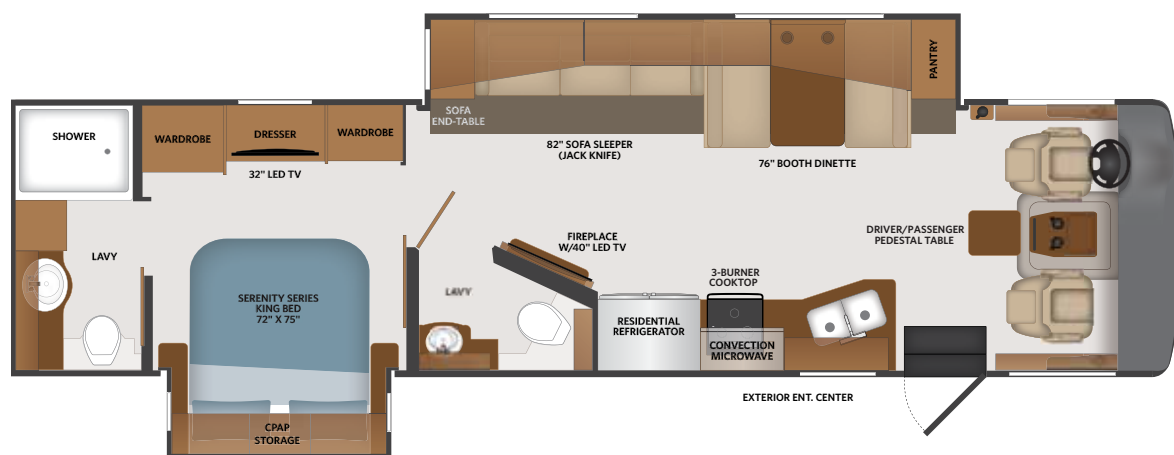
**35K**

Options: 089, 096, 113, 126, 194, 220, 304, 470, 471, 559, 580, 671, 833

TOP FLOORPLAN FEATURES

- Sleeps up to 6
- Bath-and-a-Half
- The Bounder Story
- Residential Refrigerator w/French Door and Icemaker
- Power Entry Step
- Bus-style Luggage Doors

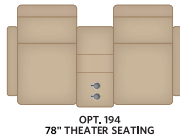
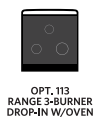

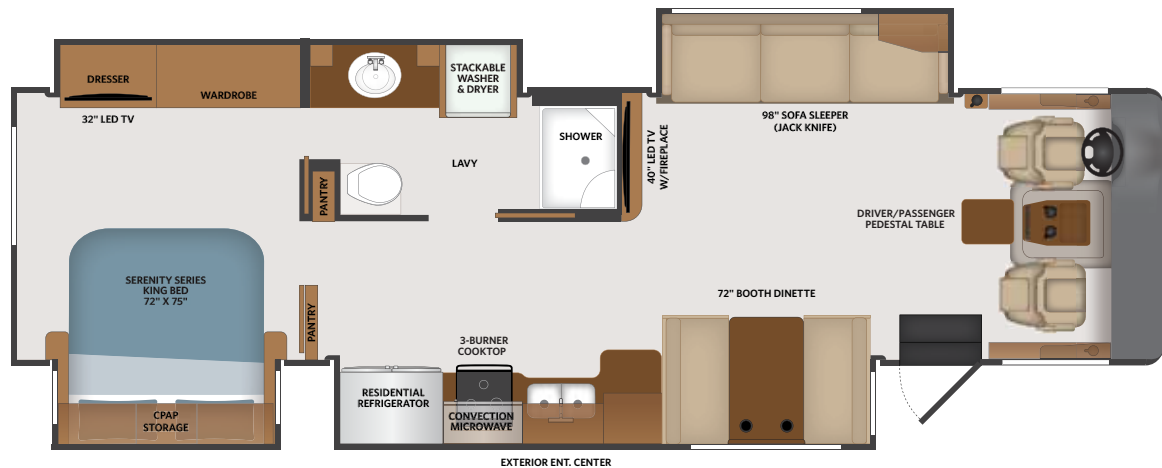

35P

Options: 089, 096, 113, 220, 304, 470, 559, 580, 671, 833

TOP FLOORPLAN FEATURES

- Sleeps up to 6
- Spacious Galley, Mid-Coach Bath
- Stackable Washer/Dryer
- Convection Microwave
- 98" Sofa w/Incliner
- Pass-through Exterior Storage

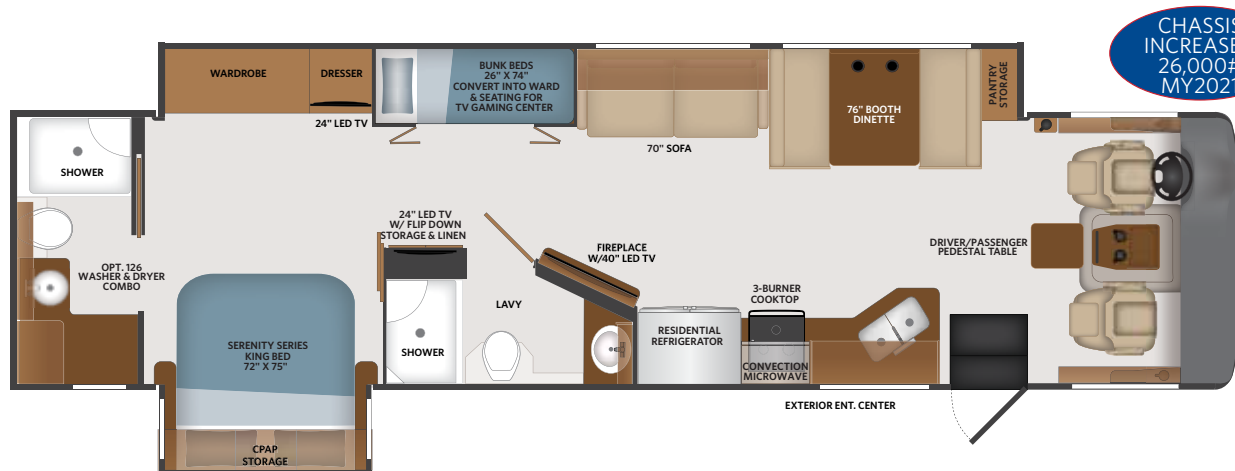

36F

Options: 089, 096, 113, 126, 194, 220, 304, 470, 559, 580, 671

TOP FLOORPLAN FEATURES

- Sleeps up to 7
- Two Full Baths
- Bunk Beds that Convert into a Large Wardrobe/Storage
- Surge Protection
- Tarkett® Flooring
- Electric Fireplace at Feature Wall
- 26,000# Chassis

BOUNDER OPTIONS

089	Upgraded WiFi Package
096	KING® Universal Satellite System
113	Range -3 Burner Drop-in w/Oven
126	Washer/Dryer — All in one combo
194	Theater Seating
220	Hide-A-Loft™ Drop Down Queen Bed with 24" LED TV
304	Solar Electrical Panel (265w)

470	SumoSprings® - Front/Rear
471	Steering Stabilizer System
559	35th Anniversary Edition*
580	Collision Mitigation
671	Manual Power Cord Reel
833	Free Standing Dinette w/Credenza

EXTERIOR GRAPHICS — Premium Four Color, Full Body Paint



CHEYENNE



SMOKE
(BASE)



BLACK



LOUBIER
BROWN



MERLOT
RED



PACIFIC

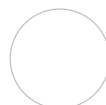

OXFORD WHITE
(BASE)



BLACK



GUNPOWDER
GREY



INTENSE
BLUE



IRON



BRIGHT SILVER
(BASE)



BLACK



GUNPOWDER
GREY

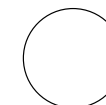

OXFORD
WHITE

ANNIVERSARY EDITION

BOUNDER 35th ANNIVERSARY EDITION INTERIOR
PAIRS WELL WITH EXTERIOR GRAPHICS

- PACIFIC
- IRON



INTERIOR DECOR

OCEANVIEW



QUICKSILVER



SYCAMORE

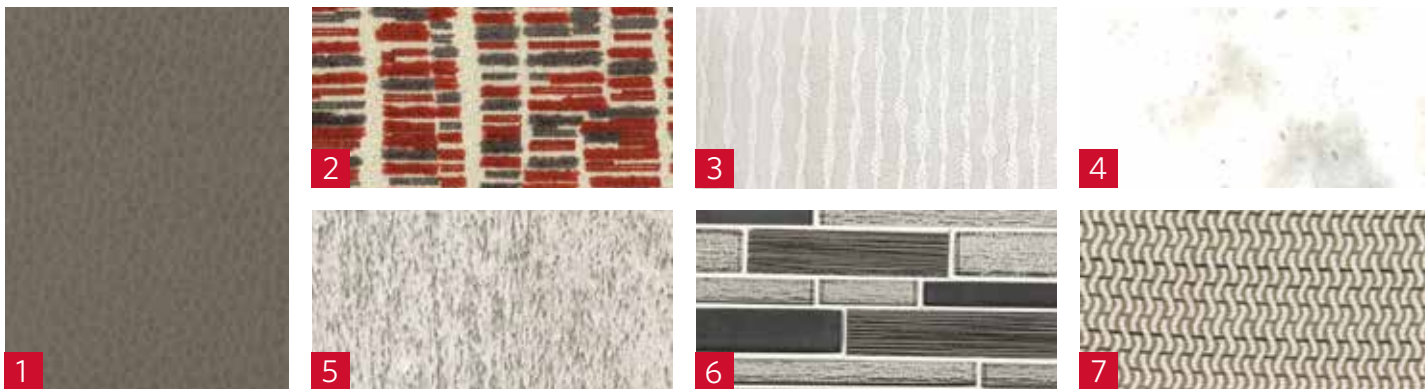

- | | | | | | | | |
|---|---------------|---|------------|---|------------|---|---------|
| 1 | SOFA | 3 | BEDSPREAD | 5 | FLOORING | 7 | VALANCE |
| 2 | LIVING ACCENT | 4 | COUNTERTOP | 6 | BACKSPLASH | | |



CAPPUCCINO



GREYSTONE



HERITAGE



OXFORD



AN EDITION WORTHY OF ITS HERITAGE

Not only has Bounder been around for 35 years, but it has the distinction of being one of the best-selling motorhome ever. Its enduring presence on the roads is a testament to the joy this model has brought to families over generations. To celebrate its legacy, we are releasing a limited Anniversary Edition that showcases what owners have come to love about Bounder. It includes several sought-after features—that are normally options—as part of the standard package. We also created two signature, custom interiors for it so your Anniversary Edition will stand out from the crowd.

Option 559

BOUNDER 35th ANNIVERSARY EDITION INCLUDES:

EXTERIOR

- Upgraded WiFi Package
- Power Cord Reel
- Solar Electrical Panel
- Garmin® Collision Mitigation
- Commemorative 35th Anniversary Badging
- Special Edition Interior Two Choices:
INSPIRATION and CELEBRATION
- 35th Anniversary Entry Tread Step Mat
- 35th Anniversary Custom Embroidery Headrests
and Accent Pillows



BOUNDER INTERIOR DECOR 35TH ANNIVERSARY EDITION

We are proud to celebrate the 35th Anniversary of the Bounder model with an Anniversary Edition available for the best-selling motorhome of all-time.

You may choose from two custom Bounder 35th Anniversary Edition interiors "Inspiration" with Greystone Cabinetry and "Celebration" with our new classical white painted wood, Heritage.

Attention to detail for the Bounder commemorative year with special exterior 35th Anniversary badging, entry tread step mat and custom embroidery anniversary logo in the headrests and accent pillows.

A limited number of 35th Anniversary Bounders Models will be produced.



INSPIRATION
35th ANNIVERSARY EDITION

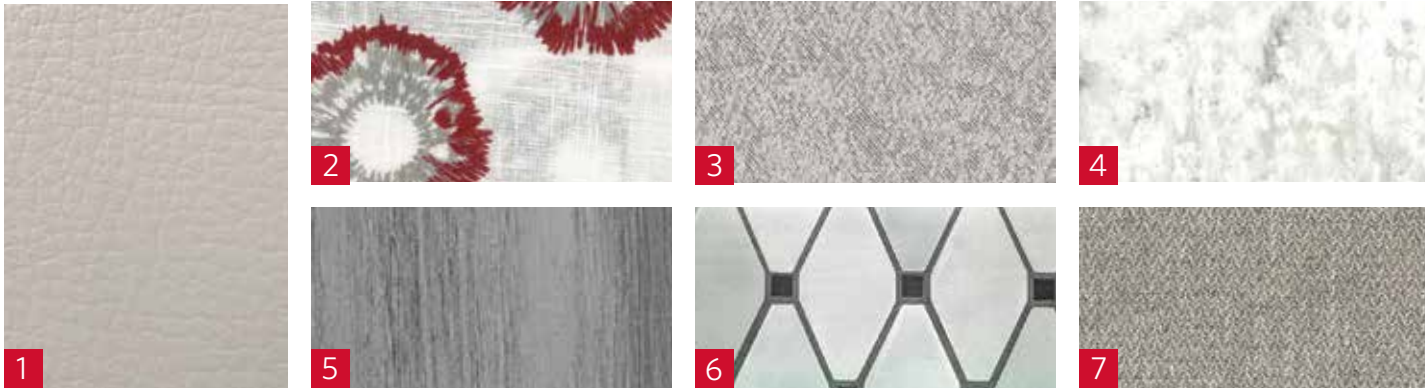

GREYSTONE

CELEBRATION
35th ANNIVERSARY EDITION

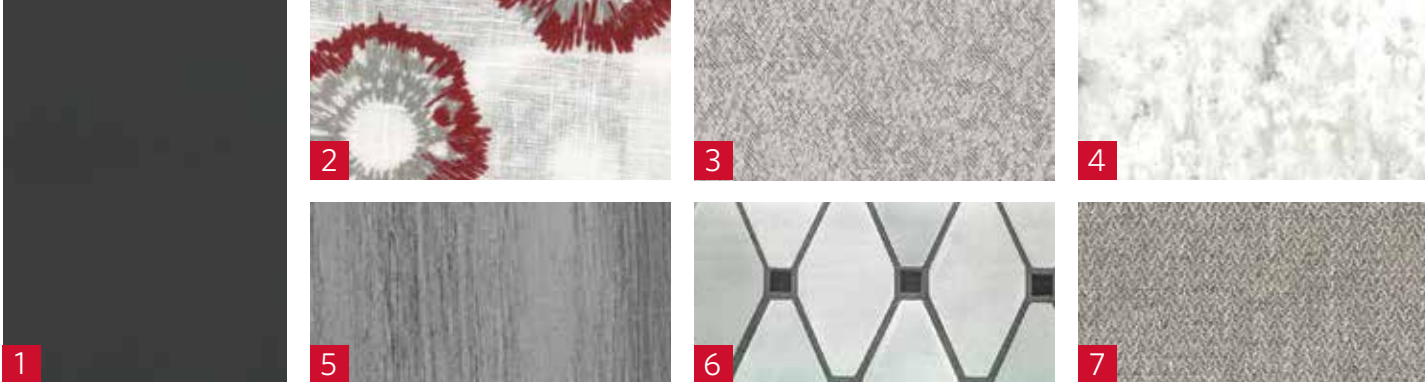

HERITAGE

- | | | | | | | | |
|---|---------------|---|------------|---|------------|---|---------|
| 1 | SOFA | 3 | BEDSPREAD | 5 | FLOORING | 7 | VALANCE |
| 2 | LIVING ACCENT | 4 | COUNTERTOP | 6 | BACKSPLASH | | |

BOUNDER

EXTERIOR	33C	35K	35P	36F
Aerodynamic Fiberglass Cap w/Automotive-Style Headlights	S	S	S	S
Rear Fiberglass Cap w/Automotive-Style Lighting	S	S	S	S
ABS Wheel Well Skirts	S	S	S	S
TPO Roof: Thermoplastic Polyolefin	S	S	S	S
Electric Patio Awning w/LED Lighting and Motion Sensor	S	S	S	S
Slideout Awning Toppers Above All Slideouts	S	S	S	S
Radiused Entry Door w/Screen Door, Latch, and Deadbolt Lock	S	S	S	S
Luggage Door Handles, Black	S	S	S	S
Acrylic Lighted Entry Grab Handle	S	S	S	S
Power Entry Step w/Light	S	S	S	S
Side-Swing Aluminum Bus-Style Baggage Doors	S	S	S	S
Dual-Pane Frameless Windows	S	S	S	S
Patio LED Light	S	S	S	S
Clearance and Marker Lighting at Front, Side, and Rear	S	S	S	S
Automatic Generator Start	S	S	S	S
Gravity Fresh Water Fill	S	S	S	S
Service Station w/Water Pump Switch, Exterior Shower, Black Tank Flush, City Water Hook-Up, and Drainage Valves	S	S	S	S
Park Cable and Satellite Hook-Up	S	S	S	S
Trailer Hitch: 7-Way Round Tow Connection (5,000 lbs.)	S	S	S	—
Trailer Hitch: 7-Way Round Tow Connection (8,000 lbs.)	—	—	—	S
TV Antenna: Unidirectional KING® Controls Jack Antenna	S	S	S	S
LP Connection	S	S	S	S
4-Point Fully-Automatic Hydraulic Leveling Jacks	S	S	S	S
Rear Ladder	S	S	S	S
Premier Paint: Full Body, 4-Color w/Front Clear Mask	S	S	S	S
Roof Vent Rain Covers	S	S	S	S

KING® Universal Satellite System	O	O	O	O
CAB EXTERIOR	33C	35K	35P	36F
Automotive-Style One-Piece Windshield	S	S	S	S
Daytime Running Lights	S	S	S	S
Driver and Passenger Tinted Slider Windows	S	S	S	S
Automotive-Style Windshield Wiper System	S	S	S	S
Remote Power and Heated Mirrors w/Turn Signals and Side Cameras, Black/Chrome	S	S	S	S
Sumo Springs	O	O	O	O
Bilstein® Stabilizer	O	O	O	O
CAB INTERIOR	33C	35K	35P	36F
Driver Chair w/Reclining Back, Swivel	S	S	S	S
Passenger Chair w/Manual Footrest, Reclining Back, and Swivel	S	S	S	S
Driver and Passenger ABS-Style Armrests	S	S	S	S
Driver and Passenger Cupholders	S	S	S	S
Power Windshield Roller Shade	S	S	S	S
Driver and Passenger Manual Roller Shades	S	S	S	S
Driver and Passenger Overhead Map Flexible Lighting	S	S	S	S
Instrument Gauges w/Electronic Information Center, Black	S	S	S	S
High-Output Dash Air Conditioning and Heat	S	S	S	S
Electronic Cruise Control	S	S	S	S
Windshield Wipers w/Delay	S	S	S	S
Remote Switch for Power and Heated Mirrors	S	S	S	S
Steering Wheel w/Tilt Column	S	S	S	S
6" Color Monitor for Side and Rear Cameras	S	S	S	S
Sony 9" Stereo w/AM/FM/Bluetooth®/ MP3/USB, Phone Control, Android® Auto and Apple® CarPlay® w/Navigation, Siri® Eyes Free, Built-In HD Radio, SiriusXM® Ready (Requires Subscription), and Backup Camera	S	S	S	S

Garmin® Collision Mitigation System	O	O	O	O
Sony® 6 1/2" Stereo Speakers	S	S	S	S
SiriusXM® Satellite Radio Ready (Requires Subscription)	S	S	S	S
USB and Auxiliary Inputs	S	S	S	S
3-Point Driver and Passenger Seatbelts w/Adjustable Straps	S	S	S	S
12V Accessory Ports	S	S	S	S
110V AC Outlets	S	S	S	S
Automotive-Style Dash w/Dual Monitors and Workstation	S	S	S	S
Pull-Out Center Dash Storage Bin	S	S	S	S
Cab Lights	S	S	S	S
Generator On/Off Switch	S	S	S	S
Battery Booster Switch	S	S	S	S
Engine Cover w/Snack Tray	S	S	S	S
Cab Floor Mats	S	S	S	S
Cab Area Fans	S	S	S	S
Automatic Leveling Jack Controls	S	S	S	S
Driver and Passenger Center Table	S	S	S	S
Auxiliary Start Switch	S	S	S	S
Hide-A-Loft™ Drop-Down Queen-Sized Bed w/24" TV	O	O	O	O
INTERIOR	33C	35K	35P	36F
Sofa: Tri-Fold	—	—	—	S
Sofa: Tri-Fold w/Facing Booth Dreameasy® Dinette	—	—	S	—
Sofa: Jackknife	S	S	—	—
Sofa: Theater Seating	O	O	—	O
Facing Booth Dinette w/Dreameasy® Dinette Table	S	S	S	S
Free-Standing Dinette w/Credenza	O	O	O	—
Solid-Surface Galley Top	S	S	S	S
Surf(x)® Tops Throughout (Excluding Galley)	S	S	S	S
Electric Fireplace	S	S	S	S
Feature Wall w/Accent Wall Covering	S	S	S	S
Flat Ceiling w/Soft-Touch Vinyl	S	S	S	S
Vinyl Tile Flooring Throughout	S	S	S	S

Ozite-Lined Cabinet Interiors	S	S	S	S
Cedar-Lined Wardrobe Interiors (Select Locations)	S	S	S	S
Full-Extension Drawer Guides w/Latches	S	S	S	S
Hidden Euro-Style Hinges and Struts	S	S	S	S
Solid Wood Raised-Panel Cabinet Doors	S	S	S	S
Interior Wood Color Coordinating Slideout Fascia	S	S	S	S
Window Valances w/Lambrequins	S	S	S	S
Manual Day and Night Roller Shades	S	S	S	S
Energy-Efficient 3" LED Flush-Mounted Ceiling and Under Cabinet Reading Lights Throughout	S	S	S	S
Flush Floor Slideouts in Living Area	S	S	S	—
Brushed-Nickel Faucets, Fixtures and Hardware	S	S	S	S
INTERIOR ENTRY	33C	35K	35P	36F
Battery Disconnect	S	S	S	S
Metal Interior Grab Handle at Entry	S	S	S	S
Multiplex Electric Controls w/App Control	S	S	S	S
Entry Door Manual Roller Shade	S	S	S	S
Entry Steps w/Lighted Step Well	S	S	S	S
KITCHEN	33C	35K	35P	36F
Refrigerator: Samsung® Residential w/French Doors and Ice-maker Stainless Steel	S	S	S	S
3-Burner Cooktop w/Solid-Surface Covers	S	S	S	S
3-Burner Drop-In Range w/Oven	O	O	O	O
Stainless Steel Over-the-Range Convection Microwave	S	S	S	S
Tile Backsplash	S	S	S	S
Large Galley Window w/Tiled Window Box	S	S	—	S
Sink: Stainless Steel, Deep Double Bowl, Undermount	S	S	S	S
Solid-Surface Sink Covers	S	S	S	S
Residential Single-Handled Faucet w/Pull-Out Sprayer	S	S	S	S
Adjustable Shelves Throughout	S	S	S	S
Fan-Tastic® Power Ceiling Vent	S	S	S	S

Wastebasket	S	S	S	S
Manual Night Roller Shade	S	S	S	S
BEDROOM OR BUNK AREA	33C	35K	35P	36F
King-Sized Memory Foam Mattress	S	S	S	S
Bunk Beds (Multi-Purpose Flip Bunk for Wardrobe and Seating w/Doors)	—	—	—	S
Designer Bedspread, Headboard, Pillow Shams, and Pillows	S	S	S	S
C-PAP Machine Prep in Bedroom Overhead	S	S	S	S
120V and USB Ports	S	S	S	S
BATHROOM	33C	35K	35P	36F
Sink: Top-Mounted, Porcelain	—	S	—	—
Sink: Top-Mounted, Stainless Steel	S	S	S	S
Residential Faucet w/Single Handle	S	S	S	S
Medicine Cabinet w/Mirror	S	S	S	S
Fiberglass Shower Surround	S	S	S	S
Glass Shower Door	S	S	S	S
Shower Skylight	S	S	S	S
Metal Shower Head w/Sliding Adjustable Bar, Soap Dish, and Matching Single-Valve Faucet	S	S	S	S
Macerator Toilet, Porcelain	S	S	—	S
Standard Toilet, Porcelain	—	—	S	—
Fan-Tastic® Power Ceiling Vent	S	S	S	S
ENTERTAINMENT	33C	35K	35P	36F
40" Flat Screen LED TV (Living Area)	S	S	S	S
32" Flat Screen LED TV (Bedroom)	S	S	S	—
24" Flat Screen LED TV (Bedroom)	—	—	—	S
24" Flat Screen LED TV (Bunk Area)	—	—	—	S
24" Flat Screen LED TV (Front) Overhead w/Hide-A-Loft™ Drop-Down Bed Option	O	O	O	O
HDMI Video Distribution	S	S	S	S
Soundbar w/Blu-Ray® Player	S	S	S	S
Entertainment Center: 40" LED TV and Soundbar w/Bluetooth®	S	S	S	S
ELECTRIC AND UTILITIES	33C	35K	35P	36F
A/C: Dual 15,000 BTU w/Chill Grill and Rear Heat Pump	S	S	S	S
Furnace: 34,000 BTU	S	S	S	—
Furnace: Dual 30,000/20,000 BTU	—	—	—	S

50 Amp Service	S	S	S	S
60 Amp Power Converter	S	S	S	S
Inverter: Single 2000W Pure Sine	S	S	S	S
WiFiRanger™ Sky4	S	S	S	S
WiFiRanger™ SkyPro Pack w/LTE and GPS	O	O	O	O
100W Solar Panel	S	S	S	S
265W Solar Panel	O	O	O	O
Multiplex Wiring Control System w/7" Touch Screen Panel and App Control	S	S	S	S
Auxiliary Batteries 6V (4)	S	S	S	S
Neutral Loss Protection	S	S	S	S
Generator: 5.5kW Onan	S	S	S	S
Automatic Generator Start	S	S	S	S
Master Battery Disconnect Switch	S	S	S	S
Water Pump: 12V 3GPM High-Capacity SHURflo® Water Pump	S	S	S	—
Water Pump: 12V 5.3GPM High-Capacity AquaJet Water Pump	—	—	—	S
Water Purification System	S	S	S	S
Water Heater Bypass System	S	S	S	S
Exterior Shower	S	S	S	S
Cable TV and Satellite Hook-Up	S	S	S	S
San-T-Flush™ Black Holding Tank Flush System	S	S	S	S
Single-Location Monitor Panel w/LPG, Touch Sensor Tank Monitoring and Battery Readouts	S	S	S	S
Fire Extinguisher, LP, Carbon Monoxide, and Smoke Detectors	S	S	S	S
GFCI Receptacle in Exterior Storage	S	S	S	S
Combination Washer and Dryer	O	O	—	O
Stackable Washer and Dryer	—	—	S	—
Combination Washer and Dryer Prep	S	S	—	S
10 Gallon Water Heater	S	S	S	—
Tankless Water Heater	—	—	—	S
50 Amp Shoreline Power Cord	S	S	S	S
Power Cord Reel	O	O	O	O

BOUNDER — OUTSTANDING STANDARDS AND OPTIONS

**RENEWABLE SAFE POWER**

Save money on electricity with a 100w or optional 265w solar panel that allows you to explore untethered.

WIFI RANGER™ SKY4 DC

Boost a weak signal to get online in no time with this private secure WiFi booster.

WIFI RANGER™ SKY4 PROPACK w/LTE

Upgrade to this cellular internet modem that includes a cell booster and GPS upgrade.

**TONS OF BASEMENT STORAGE**

Bounder offers a ton of basement storage, depending on the floorplan 160-170 cu. ft.

**C-PAP READY**

This convenient storage solution is specifically designed to organize and conceal C-PAP machines while allowing for easy access and opening for hoses.

**40-INCH EXTERIOR LED TV & SOUNDBAR**

This feature adds an extra outdoor entertaining area with a 40-inch LED TV and exterior soundbar with Bluetooth®.

**ENERGY MANAGEMENT SYSTEM**

Protect your RV against the expensive electrical damage and enjoy the convenience of an auto generator start to charge batteries when they need some juice.

**HIDE-A-LOFT™ DROP DOWN BED**

Invite more guests on your road trip without compromising space with this queen bed, featuring industry-leading headroom and up to 500lb capacity. Optional feature on all floorplans and includes 24" LED TV.

**ELECTRIC FIREPLACE**

Warm up by the fire without all of the work, with an electric fireplace standard on all floorplans. Featuring a 40-inch LED TV mounted on a swing bar and includes a Bluetooth® soundbar.

**BILSTEIN® STEERING STABILIZER SYSTEM (OPTIONAL)**

Equip your Bounder with this shock absorber system that dampens the bumps and vibrations of the road in the steering system. Bilstein allows for easier control to the front-end steering.

**AUTOMOTIVE-STYLE COCKPIT**

Drive in comfort and ease in this automotive inspired dash and cockpit with dual monitors, drivers seat with reclining back and swivel. Steering wheel has tilt column, electric cruise control. Equipped with a Sony® stereo with CarPlay and front Speakers. New for 2021 is optional Garmin™ Collision Mitigation.

**BOUNDER 36F BUNK BEDS/WARDROBE**

Plenty of room for more guests on your road trip without compromising space. The Bounder 36F offers bunk beds with a dual purpose so when not in use, just flip the bunk for additional wardrobe/storage space and close off with the barn doors.

BOUNDER SPECIFICATIONS

CHASSIS	33C	35K	35P	36F
Wheelbase (inches)	208"	228"	252"	242"
Front GAWR (lbs)	8,000	8,000	9,000	9,000
Rear GAWR (lbs)	15,000	15,000	15,500	17,500
GCWR (lbs)	26,000	26,000	30,000	30,000
GVWR (lbs)	22,000	22,000	24,000	26,000
Hitch Rating Weight (lbs)	5,000	5,000	5,000	8,000
Tongue Weight (lbs)	500	500	500	800
Fuel Capacity (gal)	80	80	80	80
DIMENSIONS AND CAPACITIES	33C	35K	35P	36F
Overall Length (inches)	34' 3"	36' 3"	36' 3"	38' 9"
Overall Height (with A/C)	12' 10"	12' 10"	12' 10"	12' 10"
Overall Width (maximum)	102"	102"	102"	102"
Interior Height (maximum)	84"	84"	84"	84"
Interior Width (maximum)	96"	96"	96"	96"
Patio Awning Width (ft./in.)	17' 0"	17' 0"	14' 0"	17' 0"
Interior Storage (cu. ft.)	123	126	144	171
Exterior Storage (cu. ft.)	160	180	138	170
Fresh Water Holding Tank (gal)	100	100	100	100
Grey Water Holding Tank (gal)	58	58	46	45
Black Water Holding Tank (gal)	42	42	30	50
Appliance Propane Tank (gal) (WC)	25	25	25	25
Water Heater Tank (gal)	10	10	10	TANKLESS

Product information, photography, illustrations included in this publication were as accurate as possible at the time of printing.



FORD® CHASSIS

Model: Ford®

Engine: 7.3L Triton V8

Transmission: Ford® 6-Speed, Automatic w/Overdrive

Alternator: 175 Amp

Torque: 468 lb.-ft. @ 3,000 RPM

Horsepower: 350HP @ 3,900 RPM



DISCLAIMERS

1. GVWR (Gross Vehicle Weight Rating) is the maximum permissible weight of this fully loaded motorhome. The GVWR is equal to or greater than the sum of the (UVW) unloaded vehicle weight plus the (OCCC) occupant cargo-carrying capacity.
 2. GAWR (Gross Axle Weight Rating) is the maximum permissible loaded weight a specific axle is designed to carry.
 3. GCWR (Gross Combined Weight Rating) is the value specified by the motor home manufacturer as the maximum allowable loaded weight of this motorhome with its towed vehicle. Towing and braking capacities may be different. Refer to Fleetwood and chassis manufacturer's manuals for complete information.
 4. Length measured from front bumper to rear bumper (excludes accessories).
 5. Excludes safety equipment and awnings.
 6. Motorhomes feature a body width over 96" which will restrict your access to certain roads. Before purchasing, you should research any state and/or province road laws which may affect your usage.
 7. Tank manufacturer's listed water capacity (WC). Actual propane capacity is 80% of water listing as required by the safety code.
- † The chassis manufacturer recommends the installation of a supplemental brake control system to activate the brakes on the vehicle or trailer you are towing. Hitch receiver ratings expressed are maximum for the hitch receiver installed and may require the purchase of additional equipment that is dependent on the weight of the towed load. Consult with hitch receiver manufacturer for further information.
- * UVW and OCCC are found on the label containing the federal certification tag in each RV.
- *** All 2021 REV Recreation Group motorhomes include a limited one year/15,000-mile coach warranty and three-year/45,000-mile structural warranty, whichever occurs first, and is fully transferable for the first 12 months.



FLEETWOOD MOTORHOME ASSOCIATION

As a Fleetwood RV owner, you're invited to become a member of the Fleetwood Motorhome Association (FMA). Becoming a member is the perfect way to meet other Fleetwood owners who love to travel across America and share in the RV lifestyle. Visit the FMA website at www.fma4fun.org to learn more and join the fun.

CONTACT US

To locate a dealer near you, visit our website at www.fleetwoodrv.com or call 1-800-322-8216. We can also be contacted at Fleetwood RV Customer Relations, P.O. Box 1007, Decatur, IN 46733.

IMPORTANT—PLEASE READ: Product information, photography and illustrations included in this publication were as accurate as possible at the time of printing. For further product information and changes, please visit our website at www.fleetwoodrv.com or contact your local Fleetwood RV dealer. Prices, materials, design and specifications are subject to change without notice. All weights, fuel, liquid capacities and dimensions are approximate. Fleetwood RV has designed its recreational vehicles to provide a variety of uses for its customers. Each vehicle features optimal seating, sleeping, storage and fluid capacities. The user is responsible for selecting the proper combination of loads (i.e., occupants, equipment, fluids, cargo, etc.) to ensure that the vehicle's capacities are not exceeded.

YOUR LOCAL DEALER

Explore Your World Like Never Before



About REV Group, Inc.

REV GROUP

REV Group® (REVG) is a leading designer, manufacturer, and distributor of specialty vehicles and related aftermarket parts and services. We serve a diversified customer base, primarily in the United States, through three segments: Fire & Emergency, Commercial, and Recreation. We provide customized vehicle solutions for applications, including essential needs for public services (ambulances, fire apparatus, school buses, and transit buses), commercial infrastructure (terminal trucks and industrial sweepers) and consumer leisure (recreational vehicles). Our diverse portfolio is made up of well-established principal vehicle brands, including many of the most recognizable names within their industry. Several of our brands pioneered their specialty vehicle product categories and date back more than 50 years. REV Group trades on the NYSE under the symbol REVG. Investors-REVG



IMPORTANT—PLEASE READ: Product information, photography and illustrations included in this publication were as accurate as possible at the time of printing. For further product information and changes, please visit our website at www.fleetwoodrv.com or contact your local Fleetwood RV dealer. Prices, materials, design and specifications are subject to change without notice. All weights, fuel, liquid capacities and dimensions are approximate. Fleetwood RV has designed its recreational vehicles to provide a variety of uses for its customers. Each vehicle features optimal seating, sleeping, storage and fluid capacities. The user is responsible for selecting the proper combination of loads (i.e., occupants, equipment, fluids, cargo, etc.) to ensure that the vehicle's capacities are not exceeded.

FleetwoodRV.com

©2020 REV Group, Inc. Printed in the USA. 11/20. Model Year 2021, First Edition.

Part #: L93-0026-21



OUR VERY OWN FLEETWOOD RV MOTORHOME SERVICE CENTERS

At Fleetwood RV, we strive to deliver peace-of-mind at every turn. Our devotion to customer service starts with our trusted dealer network and spans to our own staff of motorhome service professionals at REV Recreation Group's regional technical centers. The motorhome service centers are strategically located throughout the United States to provide you convenient service wherever the road takes you.

Below, you'll find the closest motorhome service center, as well as a list of the other centers. Please visit www.fleetwoodrv.com/motorhome-service-centers to schedule a Service Appointment.

East Coast

REV RV SERVICE & REPAIR
800-509-3417

West Coast

REV RV SERVICE & REPAIR
877-466-6226

ROADSIDE ASSISTANCE. ANYWHERE. ANYTIME.

24/7 CUSTOMER SUPPORT FOR:

- FUEL
- BATTERY
- LOCKSMITH
- TOWING
- SLIDE-OUT ISSUES
- AND MUCH MORE!

1-855-268-0414



One-year of REV Assist is free with the purchase of any new 2021 Fleetwood. You may extend your coverage after the first year at www.revgroup.com/rev-assist.