



TOP FEATURES

- Freedom Bridge® Foundation
- Aqua Hot 400D
- (3) 15,000 BTU A/C units w/rear heat pump
- Full hand laid porcelain flooring throughout
- Heated floor in living area
- Safe-T-View allows your side view and backup cameras to be displayed on your interior televisions. *Acting as a built in video system*
- MultiPlex house controls that can be controlled by your smart phone or tablet
- Maintenance free citadel lined luggage compartments
- One-piece fiberglass exterior roof
Sleek appearance, low maintenance and long lasting durability
- Generous interior and exterior storage plus large holding tank capacities
- Residential style furniture by Apex Custom Furniture
- Black hardware
- New door & drawers
- New pivot door (mid-bath)

Freightliner® Custom Chassis Features

- XCM Chassis
- Cummins 6.7L, 360HP Engine
- V-Series Suspension System with the VFS Front Suspension
- V-Ride™ Technology (*enhanced stability*)
- BrakeSync (*standard*)
- Tire Pressure Monitoring (*standard*)

AVAILABLE OPTIONS

- Dishwasher
- Motion Power Lounge
- Hide-A-Loft™ Electric Drop Down Bed
- Mid-Ship LED TV (38W)
- L- Shaped Dinette (38N)
- Dream Dinette (38W)
- Free Standing Dinette w/Credenza (38K, 38N)
- Technology Package (Wi-Fi Extender Pro Pack w/LTE, Cell Booster, 330W Solar Panel, Collision Mitigation by MobileEye, FireFly Eclipse Module - enabling remote access from app via WiFi)
- Starlink Satellite
- Chrome Hardware



TO LOCATE A DEALER NEAR YOU VISIT OUR WEBSITE AT FLEETWOODRV.COM

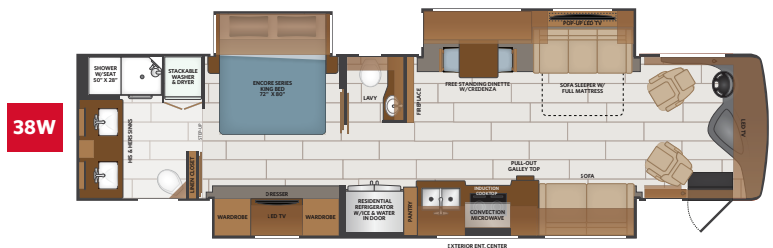
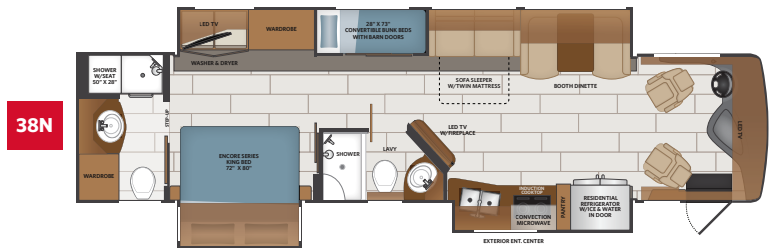
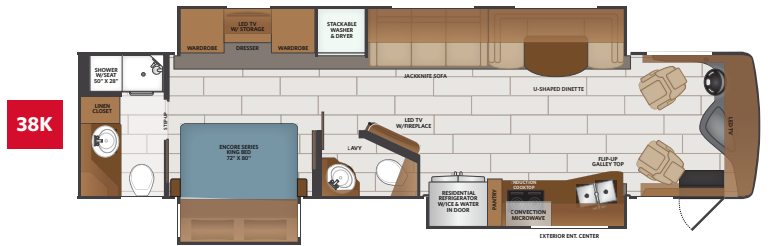

2027 CLASS A DIESEL DISCOVERY



MODELS: 38K | 38N | 38W

AMARETTO



ANTHOLOGY

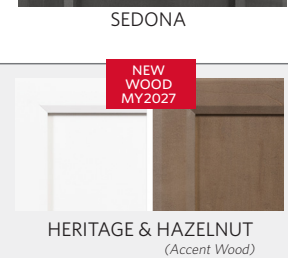
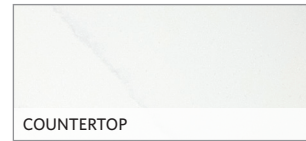
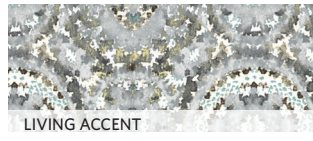

OASIS

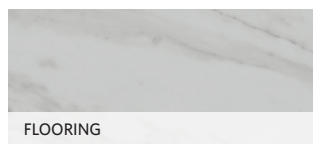
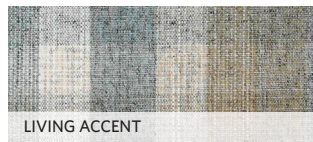
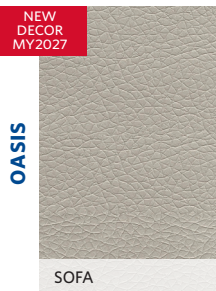

CHASSIS

MODEL	38K	38N	38W
Wheelbase	252"	252"	263"
Front GAWR (lbs)	12,600	12,600	12,600
Rear GAWR (lbs)	21,000	21,000	21,000
GCWR (lbs)	43,600	43,600	43,600
Hitch Rating Weight (lbs)	10,000	10,000	10,000
Tongue Weight (lbs)	1,000	1,000	1,000
Fuel Capacity (gal)	100	100	100

DIMENSIONS & CAPACITIES

MODEL	38K	38N	38W
Overall Length	38' 8"	38' 8"	40' 1"
Overall Height	12' 10"	12' 10"	12' 10"
Overall Width*	102"	102"	102"
Interior Height*	84"	84"	84"
Interior Width*	96"	96"	96"
Patio Awning Width	18'	18'	18'
Interior Storage (cu. ft.)	140	148	132
Exterior Storage (cu. ft.)	127	127	142
Fresh Water Capacity (gal)	105	105	105
Grey Water Capacity (gal)	75	75	75
Black Water Capacity (gal)	50	50	50

FREEDOM BRIDGE® CHASSIS

Model: Freightliner® Custom Chassis - XCM
 Engine: Cummins ISB 6.7L, 360HP
 Torque: 800 lb.-ft. @ 1,800 RPM
 Transmission: Allison® 3,000 MH 6-Speed
 Alternator: Delco Remy 160 Amp



*Overall Width, Interior Height and Interior Width measured with slide-box in.

EXTERIORS



DISCOVERY

©2026 REV RECREATION GROUP, INC. PRINTED IN USA. INVENTORY CONTROL DISCOVERY27F1, 3/26. MODEL YEAR 2027